



2023 NEW CABINET ACCESSORY PRODUCTS



Everybody
needs a
Sidekick!





SIDEKICK PULLOUT

- Designed to ONLY be mounted to 448BCSC Series pullouts*
- Natural maple construction with chrome accents
- (2) configurations available; Spices or Tray/Foil wrap holder
- Add 3" to the existing compatible* 448 footprint per sidekick (3" sidekick attached to 5" 448 fits in an 8" opening)
- Full-extension, ball-bearing slide w/ soft-close
- Slides independently providing complete access to the attached 448
- TSCA Title VI compliant

* Not compatible with 448SW, 448-BCBBSC, 448-BC, 448-BDDSC or 448-BC19SC-5C reduced depth pullouts



448BSKT3C
Sidekick Pullout Tray/Foil Wrap Holder



448BSKS3C
Sidekick Pullout Spice Holder

Sidekick Pullout

PRODUCT	DESCRIPTION	DIMS
448BSKT3C	448 Sidekick Accessory Tray, Foil Wrap Holder	3" (76 mm) W x 20-3/4" (527 mm) D x 23-15/16" (608 mm) H
448BSKS3C	448 Sidekick Accessory Spice Holder	3" (76 mm) W x 20-3/4" (527 mm) D x 23-15/16" (608 mm) H



FLEXIBLE DRIP TRAYS

- Designed for Face frame & Full Access 27" to 42" sink base cabinets or 24" to 36" vanity sink base cabinets
- Flexible, durable and easy-to-clean TPE construction, gray
- Trimmable
- Drop-in installation
- Funnels excess water out the front of your cabinet
- Can be installed in existing cabinet construction

Flexible Drip Tray

PRODUCT	DESCRIPTION	DIMS	MIN TRIM	CAB	FINISH
SBDTF2730141	Drip Tray	28-1/2" (724 mm) W x 23-1/4" (591 mm) D x 3/4" (19 mm) H	25-1/2" (648 mm) W x 21-1/2" (546 mm) D	SB-27-30	Gray
SBDTF3336141	Drip Tray	34-1/2" (876 mm) W x 23-1/4" (591 mm) D x 3/4" (19 mm) H	31-1/2" (800 mm) W x 21-1/2" (546 mm) D	SB-33-36	Gray
SBDTF3942141	Drip Tray	40-1/2" (1029 mm) W x 23-1/4" (591 mm) D x 3/4" (19 mm) H	37-1/2" (953 mm) W x 21-1/2" (546 mm) D	SB-39-42	Gray

Vanity Flexible Drip Tray

SBVDTF2124141	Drip Tray	22-1/2" (572 mm) W x 20-1/4" (515 mm) D x 3/4" (19 mm) H	19-1/2" (495 mm) W x 18-1/2" (470 mm) D	VSB-21-27	Gray
SBVDTF2730141	Drip Tray	28-1/2" (724 mm) W x 20-1/4" (515 mm) D x 3/4" (19 mm) H	25-1/2" (648 mm) W x 18-1/2" (470 mm) D	VSB-27-30	Gray
SBVDTF3336141	Drip Tray	34-1/2" (876 mm) W x 20-1/4" (515 mm) D x 3/4" (19 mm) H	31-1/2" (800 mm) W x 18-1/2" (470 mm) D	VSB-33-36	Gray



DOOR-MOUNT PAPER TOWEL HOLDER

- Designed for Face frame & Full Access 36" sink base cabinets
- Lift-out design to replace your paper towels
- Natural maple construction with semi-gloss finish
- Patented adjustable door-mount brackets that provide up to 5" of adjustability (US Patent No. 7,204,569)
- Tear bar ensures an easy one-handed tear every time
- Lower shelf for additional storage
- Mounts to cabinet door
- Will work in frameless 30" sink base
- TSCA Title VI compliant

Sink Base Paper Towel Holder

PRODUCT	DESCRIPTION	DIMS	MCO	CAB	FINISH
4SBPT181	Paper Towel Holder	13-1/2" (343 mm) W x 7-11/32" (187 mm) D x 18-1/2" (470 mm) H	14-3/8" (366 mm)	SB36	Maple



WOOD BOTTOM-MOUNT HAMPER

- Designed for Face frame & Full Access 24" base cabinets
- Natural maple dovetail construction with a semi-gloss finish
- Full-extension, undermount slides w/ BLUM soft-close
- Patented door-mount brackets with 5" of adjustability and micro-trim adjuster (US Patent No. 8,388,076)
- (1) reversible left-hand or right-hand mounted compartment
- (2) Configurations
 - D (1) 1.5 BU (56 qt.) hamper (1) 1.7 qt. OXO container and maple beauty ring
 - FH (1) 2.3 BU (86 qt.) hamper, (1) 1.7 qt. OXO container and maple beauty ring
- Mounts to cabinet floor and door
- TSCA Title VI compliant

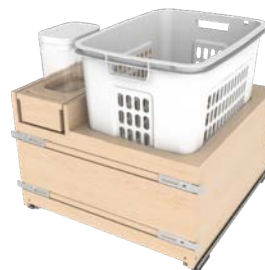

Includes:
 (1) 1.5 or 2.3 Bushel hamper, (1)
 1.7 qt. OXO container and maple
 beauty ring
 (Note: Lid included with full-height unit)



Wood Hamper with OXO and Storage w/ BLUM Soft-Close

PRODUCT	DESCRIPTION	DIMS	MCO	CAB	FINISH
4WHOX24DMSC1	1.5 BU Hamper (56 qt.) w/ Storage	21" (534 mm) W x 22" (559 mm) D x 19-15/16" (507 mm) H	21" (534 mm)	B24	Maple/White
4WHOX24FHDMSC1	2.3 BU (86 qt.) Hamper w/ Storage	21" (534 mm) W x 22" (559 mm) D x 24-1/2" (623 mm) H	21" (534 mm)	FHB24	Maple/White



MAPLE BOTTOM-MOUNT WASTE CONTAINER

- Designed for Face frame & Full Access 24" door/drawer base cabinets
- Natural maple dovetail construction with a semi-gloss finish
- Full-extension, undermount slides w/ BLUM soft-close
- Patented door-mount brackets with 5" of adjustability and micro-trim adjuster (US Patent No. 8,388,076)
- (1) reversible left-hand or right-hand mounted compartment
- Included accessories: (2) 35 qt., BPA-free polymer containers, white, (2) lids, white, and (1) 1.7 qt. OXO container
- Mounts to cabinet floor and door
- TSCA Title VI compliant



Wood Bottom-Mount Waste Container with OXO and Storage w/ BLUM Soft-Close

PRODUCT	DESCRIPTION	DIMS	MCO	CAB	FINISH
4WCOX24DMSC1	Double 35 qt. w/ OXO & Storage	21" (534 mm) W x 22" (559 mm) D x 20-11/16" (526 mm) H	21" (534 mm)	B24	Maple/White



MAPLE BOTTOM-MOUNT WASTE CONTAINER

- Designed for 15" and 24" base cabinets
- Double 27 and 32 qt. polymer containers, metallic silver
- Natural maple dovetail frame with semi-gloss finish
- Full-extension with 3/4" over-travel, undermount slides w/ BLUM soft-close
- Mounts to cabinet door and floor
- Patented door-mount brackets with 5" of adjustability and micro-trim adjuster (US Patent No. 8,388,076)
- TSCA Title VI compliant



Maple Bottom Mount Waste Container w/ BLUM Soft-Close

PRODUCT	DESCRIPTION	DIMS	MCO	CAB	FINISH
4WCSC1527DM212	Double 27 qt.	12" (305 mm) W x 22-1/8" (563 mm) D x 19-11/32" (491 mm) H	12" (305 mm)	B15	Maple/Metallic Silver
4WCSC2432DM212	Double 32 qt.	20-1/2" (528 mm) W x 22-1/32" (560 mm) D x 19-11/32" (491 mm) H	21" (534 mm)	B24	Maple/Metallic Silver



4VLWCSC1527DM2

WOOD VALUE LINE BOTTOM-MOUNT WASTE CONTAINER

- Designed for 15" and 24" base cabinets
- Double 27 and 32 qt. polymer containers, white
- Dovetail plywood box w/ semi-gloss finish
- Full-extension, concealed slides w/ soft-close
- Rear storage with all single units
- Mounts to cabinet door and floor
- Patented door-mount brackets with 5" of adjustability and micro-trim adjuster (US Patent No. 8,388,076)
- Patented mounting straps (US Patent No. 9,756,941)
- TSCA Title VI compliant



Wood Value Line Bottom Mount Waste Container w/ Soft-Close

PRODUCT	DESCRIPTION	DIMS	FF MCO	FL MCO	CAB	FINISH
4VLWCSC1527DM18	Double 27 qt.	11-1/2" (293 mm) W x 21-1/2" (547 mm) D x 19-11/16" (501 mm) H	11-1/2" (293 mm)	11-3/4" (299 mm)	B15	Maple/White
4VLWCSC2432DM12	Double 32 qt.	20-1/2" (528 mm) W x 21-1/2" (547 mm) D x 19-17/32" (497 mm) H	20-1/2" (521 mm)	20-3/4" (528 mm)	B24	Maple/White



4WDIV361

ADJUSTABLE DEEP DRAWER DIVIDER INSERT

- Designed for 36" or smaller base cabinet deep drawers
- Trim-to-fit existing drawer
- Installs w/ (4) screws
- Maple construction with semi-gloss finish
- Each 4WDIV comes w/ (2) notched dividers and (3) cross dividers
- Insert kits include:
 - 24" - (2) standard dividers
 - 30" - (3) standard dividers
 - 36" - (4) standard dividers
- TSCA Title VI compliant

Adjustable Deep Drawer Divider Insert

PRODUCT	DESCRIPTION	DIMS	CAB	FINISH
4WDIV241	24" Deep Drawer Divider	18-3/4" (477 mm) W x 19-13/16" (504 mm) D x 6" (153 mm) H	B24	Maple
4WDIV301	30" Deep Drawer Divider	24-3/4" (629 mm) W x 19-13/16" (504 mm) D x 6" (153 mm) H	B30	Maple
4WDIV361	36" Deep Drawer Divider	30-3/4" (782 mm) W x 19-13/16" (504 mm) D x 6" (153 mm) H	B36	Maple



TIERED MAXX DRAWER

- Designed for 24" base face frame cabinet drawers
- Complete drawer system, just add your drawer front
- Easy installation
- Natural maple construction with semi-gloss finish
- Full-extension, undermount slides w/ BLUM soft-close
- 5/8" drawer side walls
- (5) drawer compartments
- Comes with (8) short dividers, (5) long dividers and (26) clips
- Mounts to cabinet drawer front, rear and sidewalls
- Figure 8 door mount brackets
- TSCA Title VI compliant



Tiered MAXX Drawer w/ BLUM Soft-Close

PRODUCT	DESCRIPTION	DIMS	MCO	CAB	FINISH
4WTMD24HSC1	Tiered Maxx Drawer	21" (533 mm) W x 21-17/32" (547 mm) D x 4-11/32" (111 mm) H	FF: 21" (533 mm) FL: 21" (533 mm)	B24	Maple



CHROME UNIVERSAL WASTE PULLOUT

- Designed for 12" and 18" base cabinets and 27", 30" and 33" Sink Base
- Universal frame configuration
- Single 20 and 32 qt. polymer containers, gray
- Chrome-plated welded wire frame
- Full-extension, ball-bearing, 100 lb. rated slides
- Clip-on handle
- RB versions come with a rear storage basket
- 4-screw installation
- Mounts to cabinet floor

Chrome Universal Waste Pullout

PRODUCT	DESCRIPTION	DIMS	MCO	CAB	FINISH
RUKD8201	Single 20 qt.	8-5/8" (219 mm) W x 15-3/4" (400 mm) D x 16-5/8" (422 mm) H 14-1/2" (368 mm) W x 15-3/4" (400 mm) D x 16-5/8" (422 mm) H	8-1/2" (216 mm) 14-1/2" (368 mm)	B12 B18	Gray/Chrome
RUKD1420RB1	Single 20 qt. w/ Rear Basket	14-1/2" (368 mm) W x 15-3/4" (400 mm) D x 16-5/8" (422 mm) H	14-1/2" (368 mm)	B18	Gray/Chrome
RUKD9321	Single 32 qt.	9-3/8" (238 mm) W x 15-3/4" (400 mm) D x 19-1/2" (495 mm) H 14-1/2" (368 mm) W x 16-7/16" (418 mm) D x 19-1/2" (495 mm) H	9-1/2" (241 mm) 14-1/2" (368 mm)	B12	Gray/Chrome
RUKD1432RB1	Single 32 qt. w/ Rear Basket	14-1/2" (368 mm) W x 16-7/16" (418 mm) D x 19-1/2" (495 mm) H	14-1/2" (368 mm)	B18	Gray/Chrome



WOOD UTENSIL TRAY INSERT

- Designed for 36" or smaller base cabinet drawers
- New shallow drawer version (2-3/8" height)
- Trim-to-fit existing drawer
- Drop-in installation
- Natural maple construction with semi-gloss finish
- Up to (2) adjustable compartments
- Up to (12) static compartments
- Shallow height sizes available
- TSCA Title VI compliant

Shallow Wood Utensil Tray Insert

PRODUCT	DESCRIPTION	DIMS	FINISH
4WUT36SH1	Shallow Height Utensil Drawer Insert	33-1/8" (841 mm) W x 22" (559 mm) D x 2-3/8" (60 mm) H	Maple
4WUTCT36SH1	Shallow Height Utensil/Cutlery Drawer Insert	33-1/8" (841 mm) W x 22" (559 mm) D x 2-3/8" (60 mm) H	Maple
4WUTKB36SH1	Shallow Height Knife Block/Utensil Drawer Insert	33-1/8" (841 mm) W x 22" (559 mm) D x 2-3/8" (60 mm) H	Maple



SWIVEL SHELF PULLOUT

- Designed for 9" and 12" full height face frame base cabinets
- Natural maple construction with a semi-gloss finish
- Full-extension, undermount slides w/ BLUM soft-close
- Patent-pending design
- Built-in "Extension Lock"
- Adjustable rear wall
- (2) swivel shelves with built-in self-centering axis system
- Adjustable accessory top shelf
- Chrome accents
- Patented door mount brackets provide 5" of door mounting adjustability and include micro door trim adjustment (US Patent No. 8,388,076)
- Mounts to cabinet door and floor
- TSCA Title VI Compliant



Swivel Shelf Pullout w/ BLUM Soft-Close

PRODUCT	DESCRIPTION	DIMS	MCO	CAB	FINISH
448SWBCSC5C	Swivel Shelf Pullout	6" (152 mm) W x 22-25/32" (579 mm) D x 25-1/2" (648 mm) H	FF: 5-3/4" (146 mm) FL: 6" (152 mm)	FHB9	Maple
448SWBCSC8C	Swivel Shelf Pullout	8-3/4" (222 mm) W x 22-25/32" (579 mm) D x 25-1/2" (648 mm) H	FF: 8-3/4" (222 mm) FL: 9" (229 mm)	FHB12	Maple



CASSEROLE DISH ORGANIZER

- Designed for 18" and 24" base cabinets
- Natural maple dovetail construction with semi-gloss finish
- Full-extension, undermount slides w/ BLUM soft-close
- Customize drawer compartment with included removable dividers
- Up to (6) dividers and (12) clips
- Mounts to cabinet floor
- TSCA Title VI compliant



Casserole Dish Organizer w/ BLUM Soft-Close

PRODUCT	DESCRIPTION	DIMS	MCO	CAB	FINISH
4CDS18SC1	Casserole Dish Organizer	14-1/2" (368 mm) W x 22-1/4" (565 mm) D x 10-1/2" (267 mm) H	FF: 14-1/2" (368 mm) FL: 14-1/2" (368 mm)	B18	Maple
4CDS24SC1	Casserole Dish Organizer	20-1/2" (521 mm) W x 22-1/4" (565 mm) D x 10-1/2" (267 mm) H	FF: 20-1/2" (521 mm) FL: 20-1/2" (521 mm)	B24	Maple



WOOD PLATE DIVIDER INSERT

- Designed for 36" or 33" (3) drawer base cabinet
- Natural maple construction with semi-gloss finish
- Trim-to-fit existing drawer
- Drop-in installation
- (16) compartments
- Holds (8) small plates up to 1" thick, and 8-1/4" in diameter and (8) large plates 1-1/4" thick, and 10-3/4" in diameter
- TSCA Title VI compliant

Wood Plate Divider Insert

PRODUCT	DESCRIPTION	DIMS	MCO	FINISH
4PDI36	36" Wood Plate Divider Insert	33-3/32" (841 mm) W x 22" (550 mm) D x 3-3/32" (79 mm) H	DB36-3 & DB33-3	Maple

Minimum Trim: 28-1/2 (571 mm) x 18" (457 mm)



PILASTER UTENSIL PULLOUT

- Pullout drawer designed for 18" and 24" base cabinets
- Designed to be used with our 4PIL-21* Pilaster uprights
- Natural maple dovetail construction with semi-gloss finish
- Included accessories; (1) 2 qt. and (2) 1.25 qt. stainless steel bins and (1) chrome wire basket w/ 18" or (2) 2 qt. and (3) 1.25 qt. stainless steel bins and (1) chrome wire basket w/ 24"
- Mounts to cabinet side walls
- Full-extension, undermount slides w/ BLUM soft-close
- Mount to Pilaster Rails (sold separately)
- TSCA Title VI compliant

**Designed to be used with our 4PIL-21* Pilaster uprights*



Pilaster Utensil Pullout w/ BLUM Soft-Close

PRODUCT	DESCRIPTION	DIMS	MCO	CAB	FINISH
4PUT18SC1	Pilaster Utensil Pullout	13-13/16" (350 mm) W x 21-21/32" (550 mm) D x 8-7/8" (253 mm) H	FF: 15" (381 mm) FL: 15" (381 mm)	B18	Maple
4PUT24SC1	Pilaster Utensil Pullout	19-13/16" (503 mm) W x 21-21/32" (550 mm) D x 8-7/8" (253 mm) H	FF: 21" (533 mm) FL: 21" (533 mm)	B24	Maple



UTENSIL PULLOUT

- Designed for 18" and 24" base cabinets
- Natural maple dovetail construction with a semi-gloss finish
- Full-extension, undermount slides w/ BLUM soft-close
- (1) drawer
- Includes one pull-out utensil drawer, Blumotion soft close slides, and adjustable spacers for side mounting.
- Mounts to cabinet rear and side walls



Utensil Pullout w/ BLUM Soft-Close

PRODUCT	DESCRIPTION	DIMS	MCO	CAB	FINISH
4WDUT18SCSM1	Side-Mount Utensil Pullout	16-7/16" (418 mm) - 17-9/16" (446 mm) W x 21-21/32" (550 mm) D x 8-7/8" (253 mm) H	FF: 15" (381 mm) FL: 15" (381 mm)	B18	Maple
4WDUT24SCSM1	Side-Mount Utensil Pullout	22-7/16" (570 mm) - 23-9/16" (598 mm) W x 21-21/32" (550 mm) D x 8-7/8" (253 mm) H	FF: 21" (533 mm) FL: 21" (533 mm)	B24	Maple



USB CHARGING DRAWER

- Designed for 18" full access base cabinet drawers
- Natural maple construction with semi-gloss finish
- Blum slides w/ soft-close
- In-drawer receptacle with thermal fuse protection, (4) 2.1-amp USB-A ports and (1) USB-C adapter
- The thermal fuse senses abnormal temperature and shuts off electrical power to the load on the outlet when overheating occurs.
- Max Current: USB 4.2 amp
- UL Recognized to UL962/CSA-C22.2 No. 0-10
- Power cord with NEMA 5 -15 plug
- Integrated cord guide to ensure safe operation
- Additional front storage compartment
- Door mount brackets
- Shock absorbent mat, black
- Mounts to cabinet door, rear and side walls
- Drawer front (NOT) included
- The overall safety of this product is determined by its end use
- TSCA Title VI compliant



USB Charging Drawer w/ BLUM Soft-Close

PRODUCT	DESCRIPTION	DIMS	MCO	CAB	FINISH
4WCDB18FLSC1USB	USB Charging Drawer	16-1/2" (419 mm) W x 23-1/2" (597 mm) D x 4-5/16" (110 mm) H	16-1/2" (419 mm)	FLB18	Maple



WIRE DOOR-MOUNT WASTE CONTAINER

- Designed for 30" sink base cabinets
- Single 8 L polymer container, metallic silver
- Built-in hand towel rack
- Chrome-plated wire frame
- Extended mounting bar included
- Extended mounting bar
- Mounts to cabinet door
- (1) white lid included

Wire Door-Mount Waste Container

PRODUCT	DESCRIPTION	DIMS	MCO	CAB	FINISH
5SOWC81	Single 8 L	8-7/8" (225 mm) W x 7-25/32" (198 mm) D x 13-17/32" (344 mm) H	12" (305 mm)	VB30	Chrome/Metallic Silver



BASE CABINET PULLOUT W/ UTENSIL BINS

- Designed for 9", 12" and 15" full height base cabinets
- Natural maple construction with semi-gloss finish
- Full-extension, undermount slides w/ BLUM soft-close
- (3) 1.25 qt. or (3) 2 qt. or (6) 1.25 qt. stainless steel bins
- Adjustable shelves and rear wall for added stability
- Adjustable rub bushings that prevent side to side movement
- Patented door-mount brackets with 5" of adjustability and micro-trim adjuster (US Patent No. 8,388,076)
- TSCA Title VI Compliant



Base Cabinet Pullout w/ Utensil Bins and BLUM Soft-Close

PRODUCT	DESCRIPTION	DIMS	MCO	CAB	FINISH
448UTBCSC6C	Base Organizer	7-1/8" (184 mm) W x 21-5/8" (549 mm) D x 25-1/2" (648 mm) H	FF: 7-1/2" (191 mm) FL: 7-1/2" (191 mm)	FLFHB9	Maple
448UTBCSC9C	Base Organizer	10-1/8" (260 mm) W x 21-5/8" (549 mm) D x 25-1/2" (648 mm) H	FF: 10-1/2" (268 mm) FL: 10-1/2" (268 mm)	FLFHB12	Maple
448UTBCSC11C	Base Organizer	11-5/8" (298 mm) W x 21-5/8" (550 mm) D x 25-1/2" (648 mm) H	FF: 11-1/2" (292 mm) FL: 12" (305 mm)	FHB15	Maple



BASE CABINET PULLOUT W/TRAY DIVIDER/FOIL WRAP HOLDER

- Designed for 9" and 12" base cabinets
- Natural maple construction with semi-glass finish
- Full-extension, undermount slides w/ BLUM soft-close
- Removable center divider T-Bar divider for taller items
- Patented door-mount brackets with 5" of adjustability and micro-trim adjuster (US Patent No. 8,388,076)



Base Cabinet Pullout Tray Divider/Foil Wrap Holder w/ BLUM Soft-Close

PRODUCT	DESCRIPTION	DIMS	MCO	CAB	FINISH
447BCSC6C	Base Tray Divider Pullout	7-1/8" (184 mm) W x 21-5/8" (549 mm) D x 19-1/2" (495 mm) H	FF: 7-1/2" (191 mm) FL: 7-1/2" (191 mm)	FLB9	Maple
447BCSC9C	Base Tray Divider Pullout	10-1/8" (260 mm) W x 21-5/8" (549 mm) D x 19-1/2" (495 mm) H	FF: 10-1/2" (268 mm) FL: 10-1/2" (268 mm)	FLB12	Maple



BASE CABINET PULLOUT W/KNIFE BLOCK & UTENSIL BINS

- Designed for 9" full height full access cabinets
- Natural maple construction with a semi-gloss finish
- Adjustable shelves with chrome rails
- Patented door-mount brackets with 5" of adjustability and micro-trim adjuster (US Patent No. 8,388,076)
- Full-extension, undermount slides w/ BLUM soft-close
- Mounts to cabinet door and floor
- (1) 1.25 qt. and (1) 2.0 qt. removable stainless steel bins
- TSCA Title VI Compliant



Base Cabinet Pullout w/ Knife Block and Utensil Bins w/ BLUM Soft-Close

PRODUCT	DESCRIPTION	DIMS	MCO	CAB	FINISH
448KBBSC6CC	Base Organizer	7-1/8" (184 mm) W x 21-5/8" (549 mm) D x 25-1/2" (648 mm) H	FF: 7-1/2" (191 mm) FL: 7-1/2" (191 mm)	FLFHB9	Maple



DRYING RACK DRAWER

- Designed for 24" base cabinet drawer opening
- Natural maple construction with semi-gloss finish
- Rust-resistant stainless steel rods
- Patent-pending extendable rack with variable degrees of placement
- 18 linear feet of drying space
- Requires 42" of clearance when opened
- Folds away completely when not in use
- Weight load capacity – 90 lbs.
- Full-extension, undermount slides w/ BLUM soft-close
- Figure 8 door-mount brackets
- Drawer front not included
- TSCA Title VI compliant



Wood Drying Rack w/ BLUM Soft-Close

PRODUCT	DESCRIPTION	DIMS	MCO	CAB	FINISH
4WDR24HSC1	Wood Drying Rack	21" (534 mm) W x 22" (559 mm) D x 4-13/32" (113 mm) H	21" (521 mm)	B24	Maple



Serving you across North America

CANADA

Tel.: 1 800 361-6000
Fax: 1 800 363-0193

UNITED STATES

Tel.: 1 800 619-5446
Fax: 1 800 876-7454



Follow us on

